

AMSCO Maintenance Manual



MEDI-STAT MEDICINE STATION (FOURTH GENERATION)

48" Wide 60" Wide 72" Wide

(2/89)

P-756518-091

TABLE OF CONTENTS

Section	Paragraph		Page No.	Grid
1		GENERAL INFORMATION	1-1	A-5
2		OPERATING INSTRUCTIONS	2-1	A-10
	2-1	GENERAL	2-1	A-10
	2-2	FLUORESCENT LIGHT	2-1	A-10
	2-3	HYPNOTIC-NARCOTIC COMPARTMENT	2-1	A-10
	2-4	TOWEL DISPENSER	2-1	A-10
	2-5	SOAP DISPENSER	2-1	A-10
	2-6	CUP DISPENSER	2-1	A-10
	2-7	BIOLOGICAL REFRIGERATOR	2-1	A-10
	2-8	RETRACTABLE SECURITY DOOR	2-1	A-10
	2-9	ADJUSTABLE SHELVES	2-2	A-11
3		INSPECTION AND MAINTENANCE	3-1	A-14
	3-1	GENERAL	3-1	A-14
	3-2	PERFORMANCE VERIFICATION	3-1	A-14
	3-3	CLEANING	3-1	A-14
	3-4	TROUBLESHOOTING	3-4	B-1
		TABLE 3-1. TROUBLESHOOTING CHART	3-4	B-1
4		COMPONENT REPAIR AND REPLACEMENT	4-1	B-4
	4-1	GENERAL	4-1	B-4
	4-2	BIOLOGICAL REFRIGERATION	4-1	B-4
	4-3	SECURITY DOOR	4-1	B-4
	4-4	WARNING LIGHT ACTUATOR SWITCHES	4-2	B-5
	4-5	FIELD CONVERSIONS	4-3	B-6
5		EXPLODED VIEWS AND PARTS LISTS	5-1	B-10

This document is intended for the exclusive use of AMSCO and its customers. Reproduction in whole or in part is prohibited.

©AMSCO -- 1981-1989

Printed in U.S.A.

REV. 2/89

A- 2

LIST OF ILLUSTRATIONS

Fig. No.

Page No.

Grid

2-1	HEIGHT-ADJUSTABLE SHELVES	2-2	A-11
2-2	COMPONENT LOCATIONS	2-3	A-12
3-1	ELECTRICAL SCHEMATIC	3-4	B-3
4-1	ROLLER POSITIONING	4-4	B-7
4-2	ROLLER INSTALLATION	4-4	B-7
4-3	REMOVAL OF REGULAR SLATS	4-5	B-8
4-4	ENGAGING REINFORCEMENT BAR ASSEMBLY TO REGULAR SLATS	4-5	B-8
4-5	INSTALLATION OF SOUND DAMPENER STRIP	4-5	B-8
5-1	UPPER SECTION COMPONENTS	5-2	B-11
5-2	LOWER SECTION COMPONENTS	5-4	C-1
5-3	FAUCET AND SOAP DISPENSER ASSEMBLY	5-6	C-5

SAFETY PRECAUTIONS

The following *safety precautions* should be observed when operating or servicing a Medicine Station. The page or pages on which the precautions appear in this manual is indicated by the number in the lower right-hand corner of each item.

CAUTION: When using cleaners such as *AMSCO STAINLESS STEEL CLEANER & POLISH* or *AMSCO Cleaner*, rub in a back-and-forth motion (in the same direction as the surface grain). Do not rub with a rotary or circular motion. Do not use these cleaners on painted surfaces. 3-1

WARNING: WHEN SERVICING THE BIOLOGICAL REFRIGERATOR, DO NOT ATTEMPT TO CHANGE THE REFRIGERANT CHARGE. HAVE THIS DONE BY A QUALIFIED REFRIGERATION SERVICEMAN.

WARNING: BE SURE TO DISCONNECT ELECTRICAL POWER TO THE MEDICINE STATION BEFORE PERFORMING MAINTENANCE ON ANY OF THE ELECTRICAL APPARATUS. 4-1

Service Bulletin Number						
----------------------------	--	--	--	--	--	--

Service Bulletin Number						
----------------------------	--	--	--	--	--	--

SECTION 1

GENERAL INFORMATION

The TECH DATA sheet included in this section contains factual data relating to the principal descriptive and identifying characteristics of MEDI-STAT Medicine Stations. It describes and illustrates general concepts of the equipment, its purpose, capabilities, limitations, and technical specifications.



AMSCO

MEDI-STAT
Medicine Station
• 48" • 60" • 72"

TECH
DATA

SD-143R8
(10/84)

APPLICATION

Medi-Stat Medicine Station is convenient for storing, safeguarding, controlling, and dispensing medications.

DESIGN AND CONSTRUCTION

General. The Station is a welded, stainless-steel cabinet-type structure. It is listed by either Underwriters Laboratories Incorporated or Canadian Standards Association, as applicable. We furnish all components necessary to obtain a complete working unit.

Upper Section contains

- three height-adjustable stainless steel shelves enclosed by a retractable counterbalanced security door. The shelves adjustable in 1-inch (25.4 mm) increments are sized to accommodate single- or double-width, clear-acrylic medicine boxes. Additional shelves are available. The security door is constructed of self-flame-extinguishing, rigid vinyl, interlocking members and includes a keyed lock. *Optional* stainless-steel, tiered (two-step) shelves are available. A tiered shelf can be placed on any upper-section shelf (without fasteners) to increase storage capacity and to provide easy accessibility to medication stored on shelf.
- **two-section locker** for hypnotic and narcotic drugs with separate inner doors and a single outer door. Each door has its own distinctive keyed lock. The outer door and inner door to lower section for narcotics have lock-actuated switches which energize a red warning light at the front of the Station whenever either door is unlocked. The keys cannot be removed from the inner doors until they are locked. The outer door will not close unless both



Freestanding Installation (72" Medi-Stat shown)
Typical only

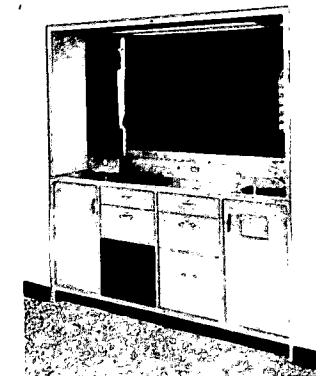

Recessed Installation
some details may vary

keys are removed from the inner-door locks. A bulletin board on the face of the outer door permits display of memos and notices. A stainless-steel shelf in the narcotics section is height-adjustable in 1-inch (25.4 mm) increments.

- a recessed fluorescent lighting fixture (installed by others) ... for general illumination of the Station ... with diffusion lens and an easy-to-reach switch.
- a plastic medicine-card rack on the side of the unit above the countertop. The rack contains twenty-four slots, each marked for a specific hour of day ... each slot holds up to 75 medicine cards. Rack includes 50 cards color coded for A.M. and P.M. use ... additional cards may be ordered — see SELECTIONS.
- a clear-acrylic cup dispenser ... for one-ounce medication cups.
- clear-acrylic medicine boxes, each with molded slot for identification card. Boxes are single-width, 6 1/8 inches long x 2 1/8 inches wide x 2 1/8 inches deep

THE SELECTIONS CHECKED BELOW
APPLY TO THIS EQUIPMENT

Size (width)

48" (1219 mm) 60" (1524 mm)
72" (1829 mm)

Mounting

- ☐ Free Standing
- ☐ Sloping Top
- Finished-end Panel(s)
 - ☐ On One End (Right or Left)
 - ☐ On Both Ends
- ☐ For Recessing

Accessories

- ☐ Medicine Boxes
 - ☐ Single Width Qty:
 - ☐ Double Width Qty:
- ☐ Identification Card Qty: Packages*
- ☐ Medicine Cards (white) Qty: Packages*
- ☐ Medicine Cards (salmon) Qty: Packages*
- ☐ Extra Shelves (for upper section)
 - ☐ 48" (1219 mm) Qty:
 - ☐ 60" (1524 mm) Qty:
 - ☐ 72" (1829 mm) Qty:
- ☐ Tiered (two-step) Shelf
 - ☐ 48" (1219 mm) Qty:
 - ☐ 60" (1524 mm) Qty:
 - ☐ 72" (1829 mm) Qty:

*1000 cards per package

Item No. _____

Location(s) _____

Service Bulletin Number						
-------------------------	--	--	--	--	--	--

(175x73x67 mm), and double-width, 6 $\frac{1}{8}$ inches long x 5 $\frac{7}{8}$ inches wide x 2 $\frac{1}{2}$ inches deep (175x149x67 mm). Nine single width boxes, six double-width boxes and fifty identification cards are furnished: additional boxes and cards may be ordered ... see SELECTIONS.

Lower section includes:

- **stainless-steel countertop and sink** with a 4-inch (102-mm) high backsplash and full-width shelf. The sink has coved corners and is 9 $\frac{1}{4}$ inches long x 12 inches wide x 7 inches deep (235x305x178 mm). It is sound deadened and includes a single chromium-plated mixing faucet (wrist-blade-controlled) and a liquid-soap dispenser with concealed reservoir. A pull-out (stainless-steel) dispenser on the backsplash holds 3 x 9 $\frac{1}{4}$ inch (76x235 mm) folded paper towels. Grounded, 120 V, 15 amp, duplex receptacle is mounted on the backsplash.
- **thermostatically controlled, self-defrosting, 4.5 cubic-foot (0.13 cubic meter) biological refrigerator** that is recessed in the lower left front of the Station. The interior contains three vacuum-formed plastic trays. The trays slide on stainless-steel channels welded to the refrigerator walls. The refrigerator (including access door) is insulated and removable (from the Station) for maintenance. The access door has a

keyed lock and a magnet-imbedded gasket which seals against the door frame. Screened ventilation holes are located in the subbase.

The motor ($\frac{1}{8}$ hp) and the air cooled, hermetically sealed condenser are in a compartment adjacent to the refrigerator, below the storage drawers. The thermostatic control (also in this compartment) permits optional manual defrosting. The refrigerator is set for temperatures between 38 and 42 F (3 and 6 C). A removable access panel, which also allows air circulation, is at the front of the compartment.

- **sound-deadened, stainless-steel storage drawers** with coved interiors. Included are two lockable drawers (four if a 72 inch (1829 mm) wide Station). A 72 inch (1829 mm) wide Station also has a bulk-storage drawer. The drawers slide on nylon rollers (in stainless-steel channels) and include rubber bumpers for quiet closing. The drawers are interchangeable.
- **storage compartment with waste facility** to enclose the sink and provide access to plumbing connections. A sound-deadened, stainless-steel door and a rear-access panel are furnished. The storage compartment door has an opening (with self-closing, stainless-steel flap) for access to a removable trash container which we furnish.

- a 4-inch (102 mm) high **welded, painted-steel reinforced base** that supports the Station and provides toe space. Base is coated for protection against corrosion.

Installation. Medi-Stat Medicine Stations are arranged primarily for recessed installation ... no trim strips required. But, optional stainless-steel sloping top and end panel or panels are available for arranging the Station as a freestanding unit. Panels are interchangeable between left- and right-hand sides.

MATERIALS

Exposed stainless-steel surfaces have a polished finish; carbon steel is phosphatized and then painted with a corrosion-resistant base primer followed by a finish coating of synthetic resinous enamel. Each application is oven-baked.

Locks are the pin-tumbler type with removable key. The inner doors on the hypnotic-narcotic locker are individually keyed and not master keyed; the outer door, storage drawers, refrigerator door, and security door are keyed alike. Locks are chromium plated and flush mounted.

Stainless-steel hinges are the full-length, semi-concealed piano type, welded to the doors and fastened to the cabinet frame by stainless-steel machine screws.

Door and drawer pulls are die-cast, chromium-plated-zinc alloy, fastened by plated machine screws.

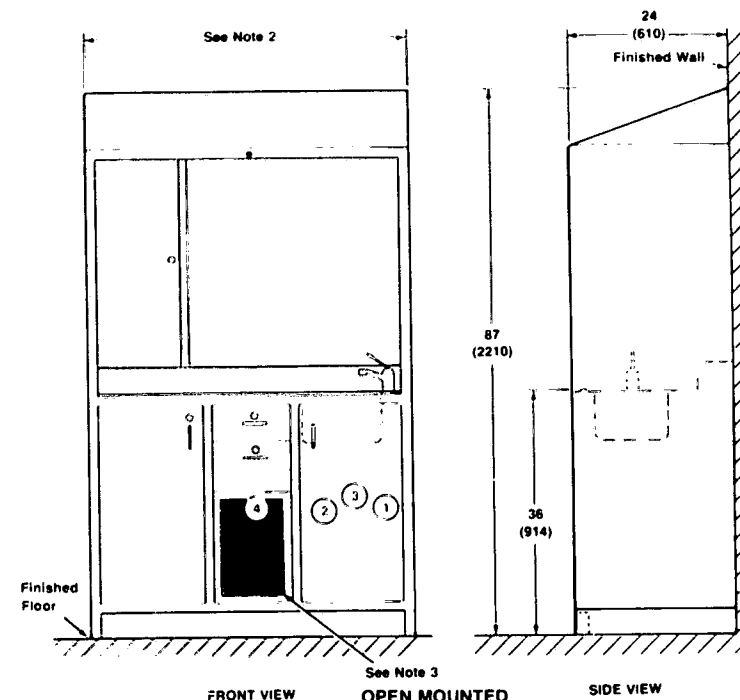

DIMENSIONS ARE INCHES (MILLIMETERS) — DRAWING IS NOT TO SCALE

OPERATING REQUIREMENTS

- ① **COLD WATER** — $\frac{3}{8}$ O.D. TUBE: 20 to 50 psig (1.4 to 3.5 kg per sq cm)
- ② **HOT WATER** — $\frac{3}{8}$ O.D. TUBE: 20 to 50 psig (1.4 to 3.5 kg per sq cm); 120 to 140 F (49 to 60 C)
- ③ **DRAIN** — 1 $\frac{1}{2}$ O.D. TUBE
- ④ **ELECTRIC** — 120 Volt, 60 Hz, 18 Amp

... CHECK LOCAL CODES ...

NOTES:

1. Pipe sizes shown are terminal outlets. Building service-supply lines to and from the equipment should be increased one pipe size to ensure optimum equipment performance.
2. Width is determined by size of Station selected: 48, 60 or 72 inches (1219, 1524 or 1829 mm).
3. A 72 inch (1829 mm) wide Station has two additional lockable drawers and one bulk storage drawer in addition to drawers shown above.
4. Approximate weights: 48 inches (1219 mm) wide, 400 lbs (182 kg); 60 inches (1524 mm) wide, 450 lbs (204 kg); 72 inches (1829 mm) wide, 500 lbs (227 kg).

See next page for recessed installation.

This print is for guidance when planning space and utility services. Actual installation prints may be obtained from any AMSCO office or representative.

SECTION 2

OPERATING INSTRUCTIONS

2-1. GENERAL

The following instructions are intended to guide the serviceman when: (1) instructing operators in techniques designed to ensure optimum equipment performance; and (2) verifying the validity of operator complaints. See Paragraph 3-4, TROUBLESHOOTING, if the Medicine Station is not operating properly. Refer to Section 1, GENERAL INFORMATION, for capabilities of the equipment.

Figure 2-2 (page 2-3) shows the Medicine Station components in their approximate locations.

2-2. FLUORESCENT LIGHT

The toggle switch for the fluorescent light is located beneath the hypnotic-narcotic compartment on the counter-top backsplash.

2-3. HYPNOTIC-NARCOTIC COMPARTMENT

The hypnotic-narcotic compartment is a two-section locker with separate inner doors. Each inner door has its own distinctive keyed lock. The locks are not masterkeyed and the keys may not be removed when locks are in the unlocked position. A red warning light automatically glows when either the hypnotic-narcotic compartment outer door or the narcotic section inner door is unlocked.

2-4. PAPER TOWEL DISPENSER

To refill the towel dispenser, rotate pawl fasteners (on each side of towel opening) counterclock-

wise and pull the towel-dispenser tray forward. Slide back the spring-loaded follower block and insert fresh towels (folded towel is 3 x 9-1/4"). Make sure that the flap on the first towel extends through the dispenser opening. Slide dispenser into place and rotate pawl fasteners (clockwise) until snug.

2-5. SOAP DISPENSER

To refill the soap dispenser, lift up and remove the dispensing head, pump section, and tubing assembly. Fill reservoir with 4 ounces of liquid soap. Do not fill above the pump-support shoulder.

2-6. CUP DISPENSER

Use Dixie No. 1201 (or equivalent), 1-ounce cups.

2-7. BIOLOGICAL REFRIGERATOR

To adjust the operating temperature remove the snap-in access panel adjacent to the refrigerator and rotate the thermostat control knob. The refrigerator is self-defrosting but may be defrosted manually by setting the thermostat at DEFROST.

2-8. RETRACTABLE SECURITY DOOR

Lift the security door by grasping both handles. Do not try to raise the door by a single handle or by exerting force on the lock. The door will hold at any position along its length of travel except near the end points.

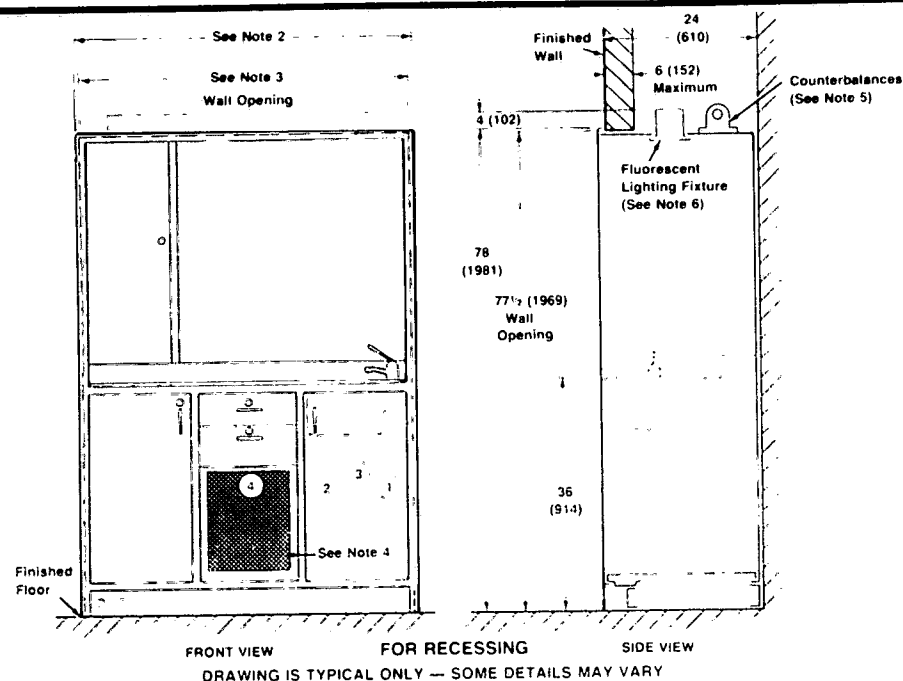

DIMENSIONS ARE INCHES (MILLIMETERS) — DRAWING IS NOT TO SCALE

OPERATING REQUIREMENTS

- ① COLD WATER — 3/8 O.D. TUBE, 20 to 50 psig (1.4 to 3.5 kg per sq cm)
- ② HOT WATER — 3/8 O.D. TUBE; 20 to 50 psig (1.4 to 3.5 kg per sq cm); 120 to 140 F (49 to 60 C)
- ③ DRAIN — 1 1/2 O.D. TUBE
- ④ ELECTRIC — 120 Volt, 60 Hz, 18 Amp

... CHECK LOCAL CODES ...

NOTES

1. Pipe sizes shown are terminal outlets. Building service-supply lines to and from the equipment should be increased one pipe size to ensure optimum equipment performance.
2. Width is determined by size of Station selected: 48, 60 or 72 inches (1219, 1524 or 1829 mm).
3. Allow one inch (25.4 mm) less than Station width for wall opening.
4. A 72 inch (1829 mm) wide Station has two additional lockable drawers and one bulk storage drawer in addition to drawers shown above.
5. The two counterbalancing units must be lowered prior to placing Station in wall opening. Refasten counterbalances through lighting fixture opening after Station is in place.
6. Fluorescent lighting fixture is to be installed after Station has been placed in wall opening and counterbalances have been refastened.
7. Approximate weights: 48 inches (1219 mm) wide, 400 lbs (182 kg); 60 inches (1524 mm) wide, 450 lbs (204 kg); 72 inches (1829 mm) wide 500 lbs (227 kg).

This print is for guidance when planning space and utility services. Actual installation prints may be obtained from any AMSCO office or representative.

Service Bulletin Number									
----------------------------	--	--	--	--	--	--	--	--	--

2-9. ADJUSTABLE SHELVES

Open the security door. Remove the spring clips which hold the shelves. Adjust shelves to the heights desired. Use the spring clips as shown in Fig. 2-1 to prevent the shelves from lifting up and subsequently tipping over. If necessary, bend the clips so that sufficient tension is applied.

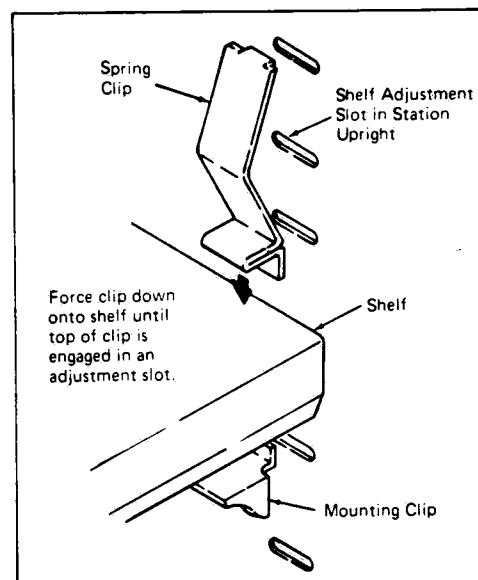

Figure 2-1. HEIGHT-ADJUSTABLE SHELVES.

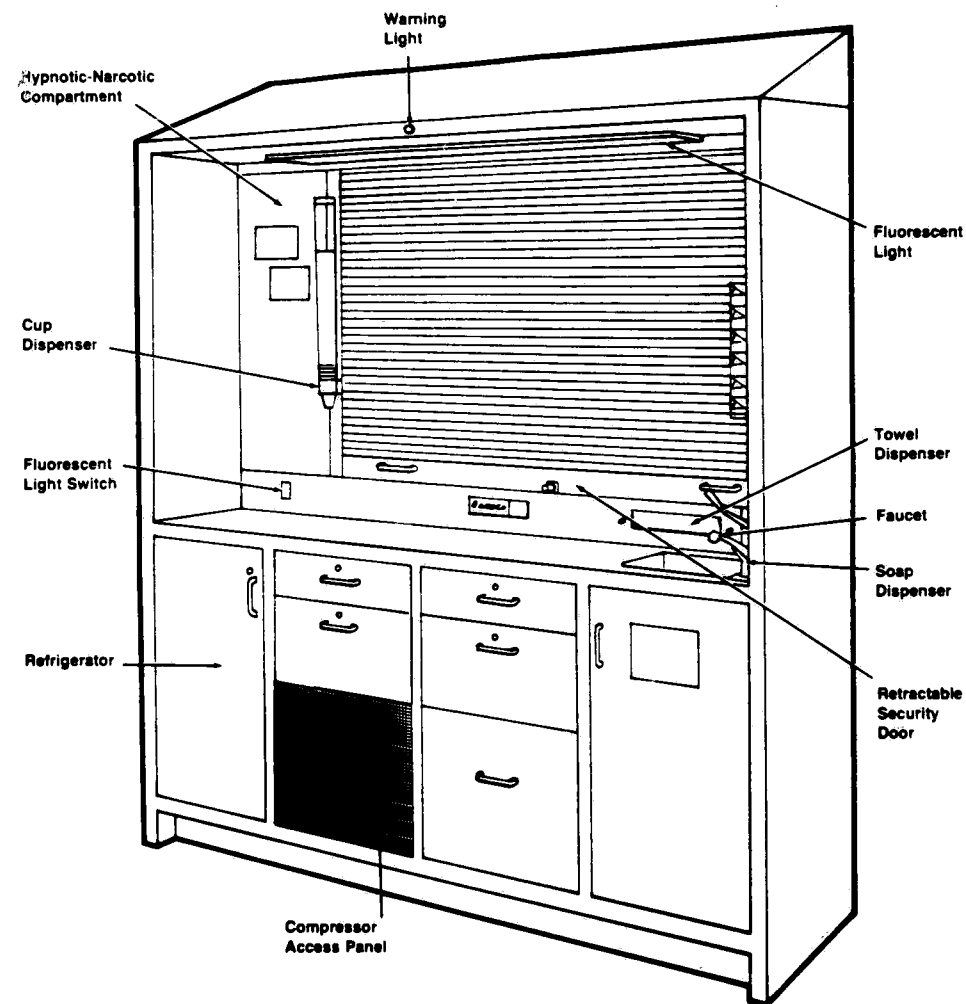

Figure 2-2. COMPONENT LOCATIONS.

Service Bulletin
Number

Service Bulletin
Number

SECTION 3

INSPECTION AND MAINTENANCE

3-1. GENERAL

The following operations with the exception of Paragraph 3-4 should be performed periodically to properly maintain a Medicine Station. The frequency, unless otherwise indicated, is determined by the usage. Refer to Paragraph 3-4, TROUBLE-SHOOTING, should a problem occur or if the Medicine Station operation is not as described in Paragraph 3-2.

3-2. PERFORMANCE VERIFICATION

1. Inspect the Medicine Station for any sign of damage, poor electrical or plumbing connections or misaligned parts.

2. Operate the water faucet and soap dispenser and inspect the drain line. Be sure they do not leak or drip.

3. Operate the overhead fluorescent light. Be sure it is working properly.

4. Check door operation as follows:

a. Be sure all locks are working properly.

b. Be sure the warning light is lit when the hypnotic-narcotic compartment outer door is open. Open the narcotic section inner door and depress the outer door switch with a screwdriver or similar instrument. Be sure the warning light remains lit.

c. Raise and lower the security door. Check for smoothness of operation. Be sure the door does not catch or bind and that no wear is apparent on any of the members that contact the door.

d. Open and close the lower storage drawers. Check for smoothness of operation. Be sure all stops are so rotated as to prevent accidental drawer removal.

5. Remove the snap-in access panel adjacent to the refrigerator. Turn the refrigerator control knob to its normal operating position. Check for proper compressor operation. Be sure the refrigerator door gasket seals tightly against the door frame. Replace the gasket if it is brittle or has cracks.

3-3. CLEANING

1. Use *AMSCO STAINLESS STEEL CLEANER & POLISH* on all stainless-steel surfaces. Apply the cleaner with a damp cloth or sponge, thoroughly wipe off and then polish with a clean, dry cloth. Use *AMSCO PRY Cleaner* to remove stubborn stains.

CAUTION: When using *AMSCO STAINLESS STEEL CLEANER & POLISH* or *AMSCO PRY Cleaner*, rub in a back-and-forth motion (in the same direction as the surface grain). Do not rub with a rotary or circular motion. Do not use these cleaners on painted surfaces.

2. Use a mild detergent solution such as Calgonite® (Calgon Corp.) to wash all nonstainless-steel surfaces (including the vinyl-surfaced bulletin board). Rinse with tap water using a sponge or damp cloth and wipe dry with a lint-free cloth.

3. Clean the refrigerator condensing-coil fins, at least once every three months, as follows: Remove the lower storage drawer (adjacent to the refrigerator) and the snap-in access panel directly below it.

THIS PAGE
INTENTIONALLY LEFT
BLANK

Service Bulletin Number						
----------------------------	--	--	--	--	--	--

Remove the top cover from the compressor assembly. Use a vacuum cleaner wand to remove any lint or dust that may have become trapped in the fins. Also, remove lint and dust from the subbase openings beneath the refrigerator. Replace the cover and drawer. Clean and replace the access panel.

3-4. TROUBLESHOOTING

1. Use the operating procedures presented in Section 2 to verify any trouble symptom or symptoms.

2. Refer to the Troubleshooting Chart (Table 3-1) after the symptom has been verified. Select the problem example that is most appropriate for the trouble symptom. Follow the recommended correction.

3. Use the electrical schematic (Fig. 3-1) to locate and understand system operation.

4. Also refer to Section 4, COMPONENT REPAIR AND REPLACEMENT, if necessary.

TABLE 3-1. TROUBLESHOOTING CHART

PROBLEM	CORRECTION
1. Fluorescent Light does not operate	<ul style="list-style-type: none"> a. Check the Fluorescent Lamp; replace if necessary b. Check the Ballast; replace if necessary c. Check the Switch; replace if necessary d. Check the Fluorescent Light circuit; correct if necessary
2. Narcotic Compartment Warning Light does not light when the outer and/or inner door is opened	<ul style="list-style-type: none"> a. Check the Bulb; replace if necessary b. Check the outer and/or inner door Switches; adjust or replace if necessary c. Check the Warning Light circuit; correct if necessary

TABLE 3-1. TROUBLESHOOTING CHART (CONTINUED)

PROBLEM	CORRECTION
3. Compressor does not start when Refrigerator is turned on	<ul style="list-style-type: none"> a. Check power supply to the refrigerator; correct if necessary b. Be sure the compressor Power Cord and Feed Line are plugged in c. Disconnect power to the Refrigerator. Remove the control housing face plate and rotate the Timer Cam until the Timer Switch actuates (switch actuator is on high lobe of cam). Restore power d. Check the Timer Switch; replace the Timer if necessary e. Check the Thermostat; replace if necessary f. Check the Compressor; be sure it is not stuck. Contact a local refrigeration serviceman for extensive repairs
4. Compressor operates but Refrigerator does not maintain set temperature	<ul style="list-style-type: none"> a. Check the Door seal; replace the Gasket if necessary b. Be sure the Condenser Fan is operating properly; correct if necessary c. Check the Condenser Coil; clean if necessary (Par. 3-3) d. Check the Thermostat; replace if necessary e. Check the Timer; replace if necessary f. Check refrigerant charge. Unit requires 4-1/2 oz R-12. Low side pressure is 5-8 psig. <div style="border: 1px solid black; padding: 5px; margin-top: 10px;"> WARNING: DO NOT ATTEMPT TO CHANGE THE REFRIGERANT CHARGE. HAVE THIS DONE BY A QUALIFIED REFRIGERATION SERVICEMAN. </div>
5. Soap Dispenser does not work	<ul style="list-style-type: none"> a. Be sure the Dispenser has an ample supply of soap b. Inspect the Dispenser; clean or replace if necessary

Service Bulletin
Number

Service Bulletin
Number

SECTION 4

COMPONENT REPAIR AND REPLACEMENT

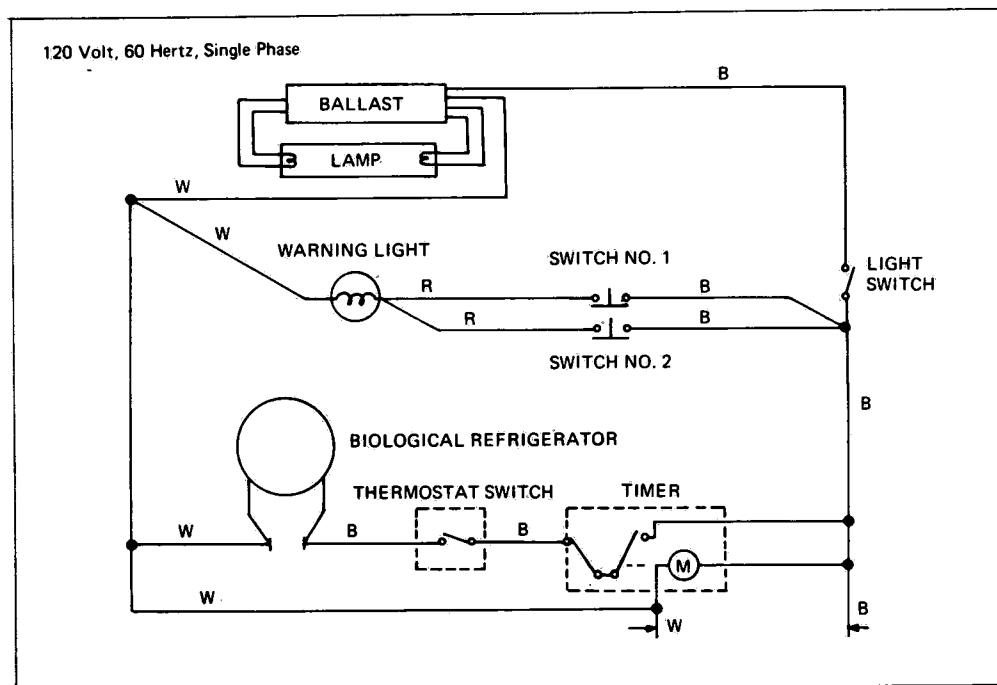

Figure 3-1. ELECTRICAL SCHEMATIC.

WARNING: BE SURE TO DISCONNECT ELECTRICAL POWER TO THE MEDICINE STATION BEFORE PERFORMING MAINTENANCE ON ANY OF THE ELECTRICAL APPARATUS.

4-1. GENERAL

This section includes instructions for the adjustment, disassembly, repair, and replacement of selected Medicine Station components. Exploded views showing the various parts and assemblies referred to in this section are included in Section 5.

4-2. BIOLOGICAL REFRIGERATOR

WARNING: DO NOT ATTEMPT TO CHANGE THE REFRIGERANT CHARGE. HAVE THIS DONE BY A QUALIFIED REFRIGERATION SERVICEMAN.

Replacing Door Gasket (Fig. 5-2)

1. Lift the gasket (18) slightly to expose the 6-32 screws which secure the gasket and the inside plate (19) to the door (17).

2. Remove the screws, gasket and inside plate.

3. Clean the gasket area, place the gasket on the plate and position them on the door. Secure the gasket and plate with the screws previously removed.

Replacing Defrost Timer (Fig. 5-2)

NOTE: The following procedure may also be used for access when replacing the control thermostat (13).

1. Disconnect electrical power to the Medicine Station. Remove the snap-in access panel (10) adjacent to the refrigerator.

2. Rotate the thermostat control knob to OFF. Remove the knob and the control housing face plate.

3. Disconnect and remove the timer (12).

4. Rotate the cam on the replacement timer until the notch in the cam is opposite the switch actuator (switch is actuated).

5. Install and connect the replacement timer. Restore electrical power.

6. Temporarily replace the thermostat knob. Rotate it to its normal operating position. The compressor should start immediately. Be sure it is operating properly.

7. Remove the knob and replace the face plate. Replace the knob and the access panel.

Repositioning Defrost Timer (Fig. 5-2)

If vibration causes the timer to malfunction (causing the refrigerator to ice up), reverse the position of the timer, as follows:

1. Remove the compressor access panel (10).

2. Disconnect electrical power supply to the compressor assembly (11) by removing the plug in the junction box, directly behind compressor assembly.

Service Bulletin
Number

B- 3

Service Bulletin
Number

B- 4

3. Remove timer/thermostat housing cover (three screws).

4. Remove two screws holding defrost timer in place.

5. Invert the timer, making sure timer bracket is pointing upward (i.e., motor is on top); it is not necessary to disconnect any wires. Reconnect the timer.

6. Replace the timer/thermostat cover.

7. Insert the plug in the junction box and replace the compressor access panel (10).

4-3. SECURITY DOOR

Replacement (Fig. 5-1)

1. Raise the door to its uppermost position.

2. Remove the four 6-32 Phillips head screws from each of the front door tracks (14). NOTE: To remove the top screw it may be necessary to raise the door slightly above its normal at-rest position.

3. Remove the tracks. Note the position of the counterbalancing door lifter (12) in each track. Remove the door from the Medicine Station.

4. Remove and replace any damaged slats (5) or, if the entire door is being replaced, preassemble the new door on a flat clean surface. Align the slats. Extend two strips of tape (on what will be the inside) over the full length of the door. Place the tape approximately 6 inches from the side edges.

5. Roll up the door, starting with the handle end.

6. Hold the rolled-up door near the top of the unit and start feeding the top of the door into the Medicine Station. NOTE: It may be necessary for two people to perform this operation to properly guide the door over the top of the track rollers (15) and into the back of the unit.

7. Unroll the entire door.

8. Slide the tracks over the door lifters. Reinstall the tracks and secure them with the screws previously removed.

9. Operate the door. Be sure it does not bind or catch. Adjust the rollers, if necessary . . . see next paragraph, "Roller Adjustment". Remove the tape from the inside of the door.

Roller Adjustment (Fig. 5-1)

NOTE: The purpose of the roller assembly (15) is to minimize the effort required to operate the security door. Some units shipped prior to 4/71 may not include roller assemblies. Instructions are provided in paragraph 4-5 for adding this feature.

1. Operate the door. Observe the position of the roller assemblies.

2. Compare the roller positions with those shown in Figure 4-1. If necessary, loosen the 1/4-20 hex head cap screw on each roller and reposition them as shown. Tighten the screws.

3. Repeat step 1. Be sure the door does not bind or catch.

Counterbalance Replacement (Fig. 5-1)

1. Open the fluorescent light diffuser frame. Remove the four 8-32 screws which secure the fixture box to the Station. Temporarily lower the box.

2. Remove and replace the defective counterbalancing unit(s).

3. Reassemble the items in reverse order.

4-4. WARNING LIGHT ACTUATOR SWITCHES

Adjustment (Fig. 5-1)

1. Disconnect electrical power to the Medicine Station.

2. Open the hypnotic-narcotic compartment doors (17 and 25). Remove the 8-32 screws securing the upper compartment shelf (23). Remove it and the lower adjustable shelf (22). Remove the filler stile assembly (right-hand upright).

3. Loosen the 4-40 switch mounting screws on the filler stile. Lightly tighten the upper screws. Tighten the lower screws so that the switches (19 and 21) will pivot with moderate pressure. Pivot the switch bottoms towards the filler stile offset.

4. Temporarily reinstall the filler stile. Lock and unlock the doors several times until the switches are properly positioned.

5. Carefully remove the filler stile and tighten the switch mounting screws. Be sure the switches do not move. Reinstall the filler stile.

6. Reapply electrical power to the unit. Open and close the doors.

a. Be sure the warning light (1) is not lit when the doors are closed.

b. Be sure the light is lit when the outer door is unlocked.

c. Open the narcotic section inner door and depress the outer door switch with a screwdriver or similar instrument. Be sure the warning light remains lit.

4-5. FIELD CONVERSIONS

Addition of Security Door Roller Assemblies

NOTE: Before starting the following procedure, it will be necessary to order two of Part No. 452799-001, Roller Assemblies (per Station). Install these assemblies, as follows.

1. Hold each assembly in position as shown in Figure 4-2 and mark the location of the oval slots on the Station uprights.

2. Drill a No. 28 hole through the Station upright at the center of each slot.

3. Fasten the roller assemblies to the Station upright with the screws provided.

4. Adjust the rollers so that they are spaced sufficiently to provide a slight lift on the door at the point where it becomes tangent to the curved portion of the track. To do so, the rollers should be positioned as shown in Figure 4-1.

a. Loosen the mounting screws. Raise or lower the entire assembly.

b. Loosen the hex head cap screws and position the individual rollers.

5. Operate the door. Be sure it does not bind or catch. Readjust the rollers if necessary.

6. After the rollers have been properly positioned, drill two No. 28 holes in the Station uprights using the 3/16" pilot holes as guides. Secure the assemblies with the screws provided.

Service Bulletin
Number

Service Bulletin
Number

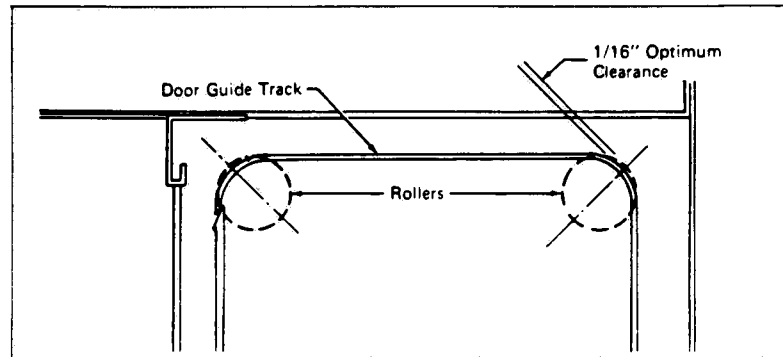

Figure 4-1. ROLLER POSITIONING.

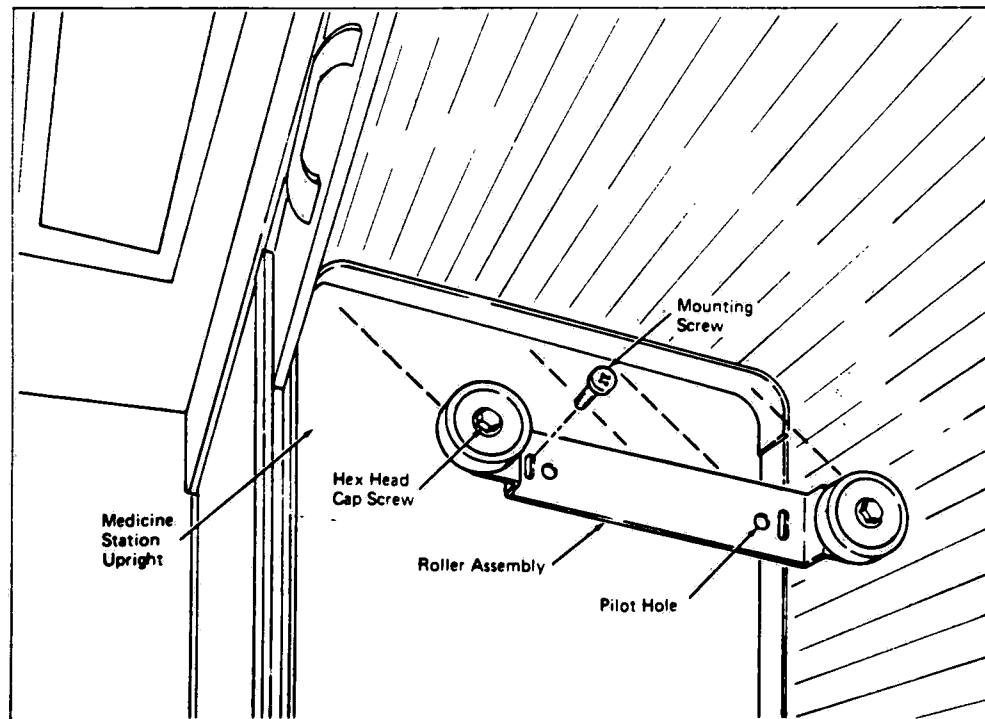

Figure 4-2. ROLLER INSTALLATION.

Service Bulletin
Number

B- 7

Reinforcement of Door on 72 inch Wide Models

Install two reinforcement bars, P-454733-003, and a sound dampener strip, P-454850-001, as follows:

1. Referring to Figure 5-1, remove the 6-32 screws that secure the right-hand door track (14) to the station.
2. Remove the right-hand door track.
3. Repeat steps 1 and 2 for the left-hand door track (14).
4. Remove roll-up door by sliding it up and over the rollers (see Figure 4-1).
5. Counting down from top of roll-up door (Figure 4-3) pull out the fourth slat.
6. Replace this regular slat with a reinforcement bar being sure that bar engages regular slats above and below it (see Figure 4-4).

7. Counting down from the regular slat below the reinforcement bar assembly pull out the eighth slat.

8. Replace this slat with a reinforcement bar being sure that bar engages regular slats above and below it (see Figure 4-4).

9. Remove paper backing from adhesive side of sound dampener strip.

10. Position sound dampener strip with adhesive side down as shown in Figure 4-5 and press strip against the metal.

11. Reassemble roll-up door by performing steps 1, 2, and 3 in reverse.

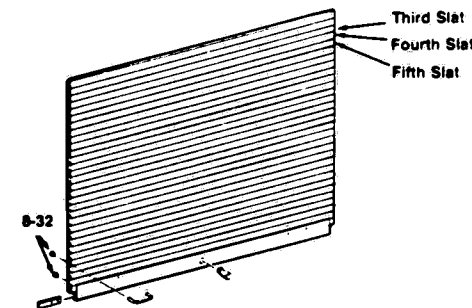

Figure 4-3. REMOVAL OF REGULAR SLATS.

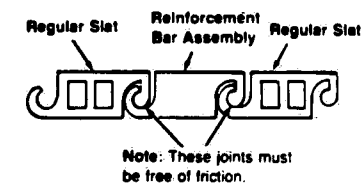
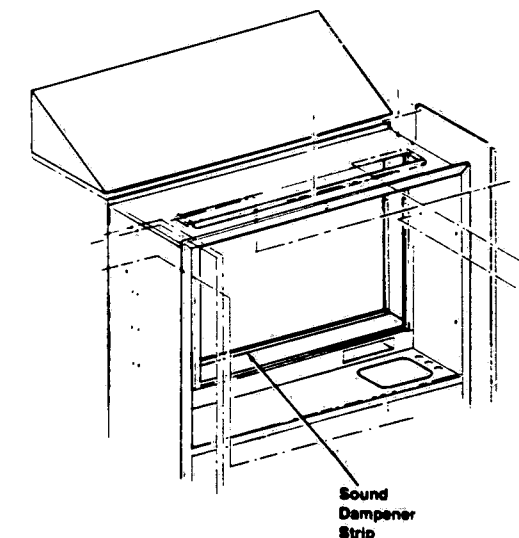

Figure 4-4. ENGAGING REINFORCEMENT BAR ASSEMBLY TO REGULAR SLATS.



Note: For complete illustration see Figure 5-1.

Figure 4-5. INSTALLATION OF SOUND DAMPENER STRIP.

Service Bulletin
Number

B- 8

SECTION 5

EXPLODED VIEWS AND PARTS LISTS

The following pages contain illustrated parts breakdowns of major Medicine Station components, illustrated and identified as follows:

Upper Section Components Figure 5-1
Lower Section Components Figure 5-2

2. Turn to the page indicated and locate the desired part on the illustration; note its index number.

3. Refer to the accompanying description for specific information regarding the part.

Index numbers are not assigned to parts with little or no maintenance replacement frequency nor to commercial hardware. Such parts are illustrated, however, merely to aid in the various assembly and disassembly procedures covered in this manual. Parts not identified on the preceeding pages should either be ordered from AMSCO (by description) or procured locally as the situation dictates. When ordering by description, include (from the illustration) the number of the assembly on which the part is located. Thread sizes (e.g., No. 8, 10-32, 1/4-20, etc.) are listed as aids in selecting proper fasteners.

The numbers, descriptions and quantities of parts listed on the subsequent pages are those required for a single Medicine Station. Subassembly components are indicated by indentation. The UNITS PER ASSEMBLY column, specific to a given assembly or subassembly, is indicated by an asterisk.

HOW TO USE THE ILLUSTRATED PARTS BREAKDOWN

1. Determine the function and application of the part required. Turn to the List of Illustrations and select the most appropriate title. Note the illustration page number.

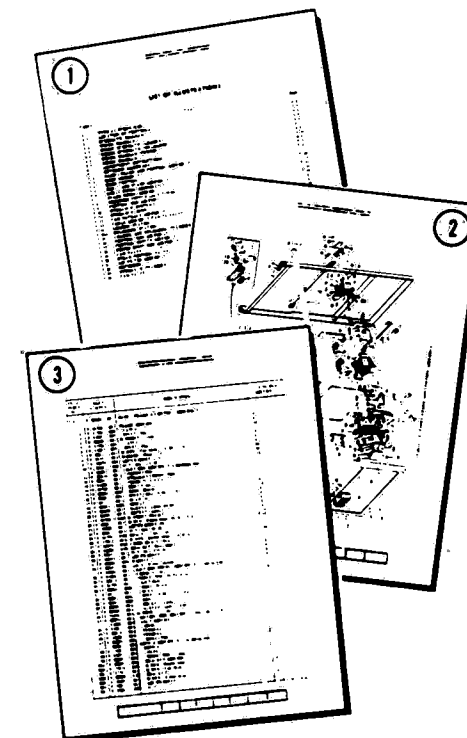

THIS PAGE
INTENTIONALLY LEFT
BLANK

Service Bulletin Number						
----------------------------	--	--	--	--	--	--

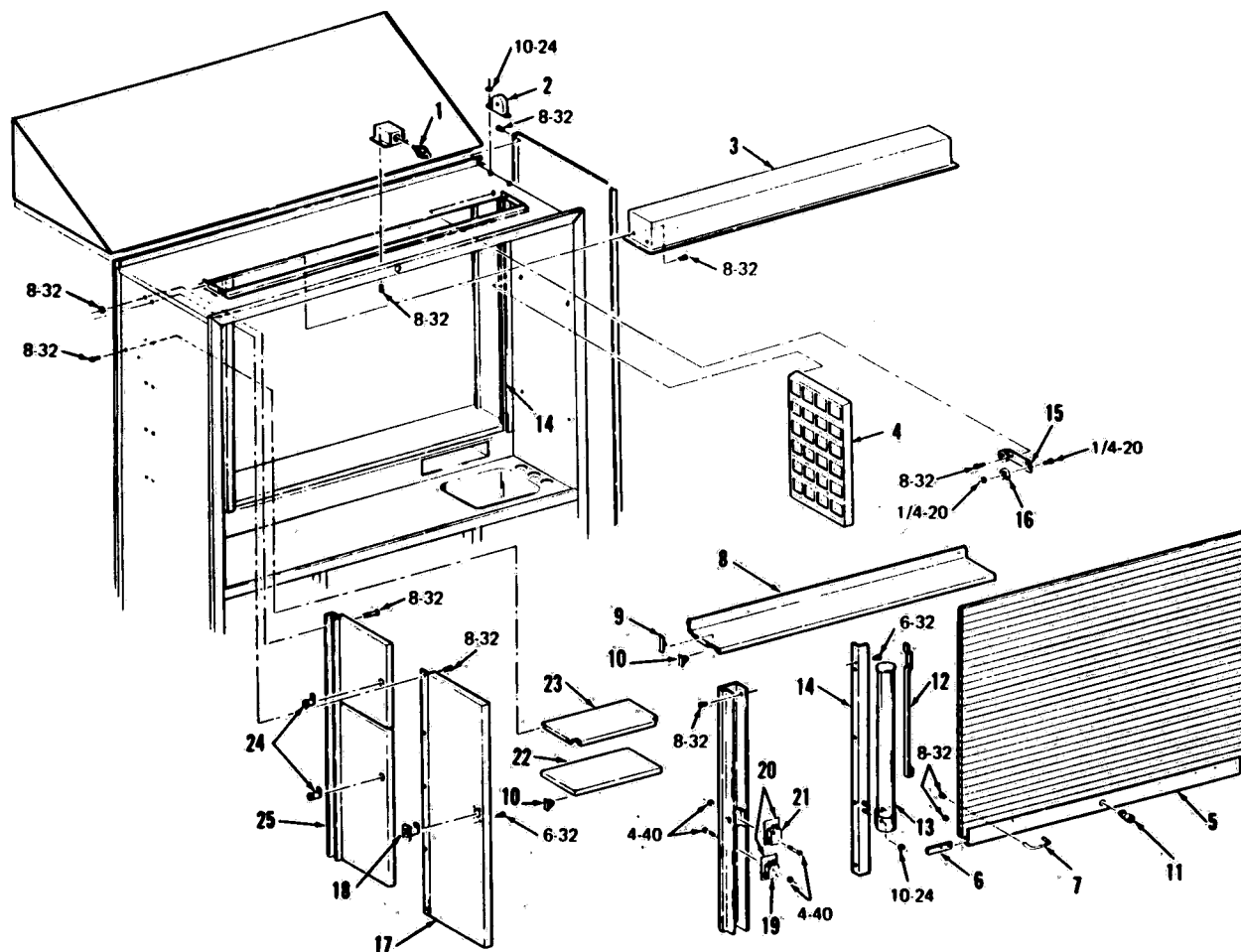

Figure 5-1. UPPER SECTION COMPONENTS.

THIS PAGE
INTENTIONALLY LEFT
BLANK

FIG. & INDEX NO.	PART NUMBER	DESCRIPTION	UNITS PER ASSEMBLY			
5-1-		UPPER SECTION COMPONENTS, 48" Medicine Station
		UPPER SECTION COMPONENTS, 60" Medicine Station
		UPPER SECTION COMPONENTS, 72" Medicine Station
	451385-091	PILOT LIGHT, Warning	1	1	1	1
1	78011-NLA	• LAMP, #120 PSB5(SUB: 764317-710)	1	1	1	1
	33257-091	• LENS (Not Shown)	1	1	1	1
2	451918-091	COUNTERBALANCE	2	2	2	2
3	451282-091	FLUORESCENT LIGHT	1	1	1	1
	451341-091	FLUORESCENT LIGHT	1	1	1	1
4	467700-091	RACK, Medicine Card	1	1	1	1
5	465467-003	DOOR, Roll-up security
	465467-002	DOOR, Roll-up security
	465467-001	DOOR, Roll-up security
	451913-091	• SLAT (31-1/16 inch Long)	56	56	56	56
	451912-091	• SLAT (43-1/16 inch Long)	56	56	56	56
	451911-091	• SLAT (55-1/16 inch Long)	56	56	56	56
6	451926-091	• GUIDE, Door	2	2	2	2
7	430061-056	• PULL, Drawer	2	2	2	2
8	460825-091	SHELF, Long (31-1/8" long)	3	3	3	3
	460829-091	SHELF, Long (43-1/8" long)	3	3	3	3
	460769-091	SHELF, Long (55-1/8" long)	3	3	3	3
9	452356-091	CLIP, Retaining	6	6	6	6
10	431121-091	CLIP, Mounting (Bends Up)	16	16	16	16
	430031-091	CLIP, Mounting (Bends Down)	16	16	16	16
11	452367-056*	LOCK with keys, Security door	1	1	1	1
12	460858-091	LIFTER, Door	2	2	2	2
13	430147-091	DISPENSER, Cup	1	1	1	1
14	451893-091	TRACK, Door (left-hand)	1	1	1	1
	451924-091	TRACK, Door (right-hand)	1	1	1	1
15	452799-001	ROLLER ASSEMBLY, Security door
16	452800-001	• BEARING, Roller	2	2	2	2
17	460771-091	DOOR, Outer	1	1	1	1
18	431117-056*	LOCK with keys, Outer door	1	1	1	1
	460803-091	FILLER STILE ASSEMBLY
19	451231-091	• SWITCH, Warning light	1	1	1	1
20	451909-091	• INSULATION, Switch	2	2	2	2
21	451230-091	• SWITCH, Warning light	1	1	1	1
22	451897-091	SHELF, Short (13-9/16" long)	1	1	1	1
23	460770-091	SHELF, Fixed	1	1	1	1
24	451906-056*	LOCK with keys, Inner door	2	2	2	2
25	460774-091	DOOR ASSEMBLY, Inner	1	1	1	1
	454856-001	PANEL, Back 31" Long (Not Shown)	1	1	1	1
	454856-002	PANEL, Back 43" Long (Not Shown)	1	1	1	1
	454856-003	PANEL, Back 55" Long (Not Shown)	1	1	1	1
	454858-001	CLIP (Not Shown)	A/R	A/R	A/R	A/R

*To enable the use of existing keys, also specify the key number stamped on the original lock and keys with each replacement order.

Service Bulletin Number									
----------------------------	--	--	--	--	--	--	--	--	--

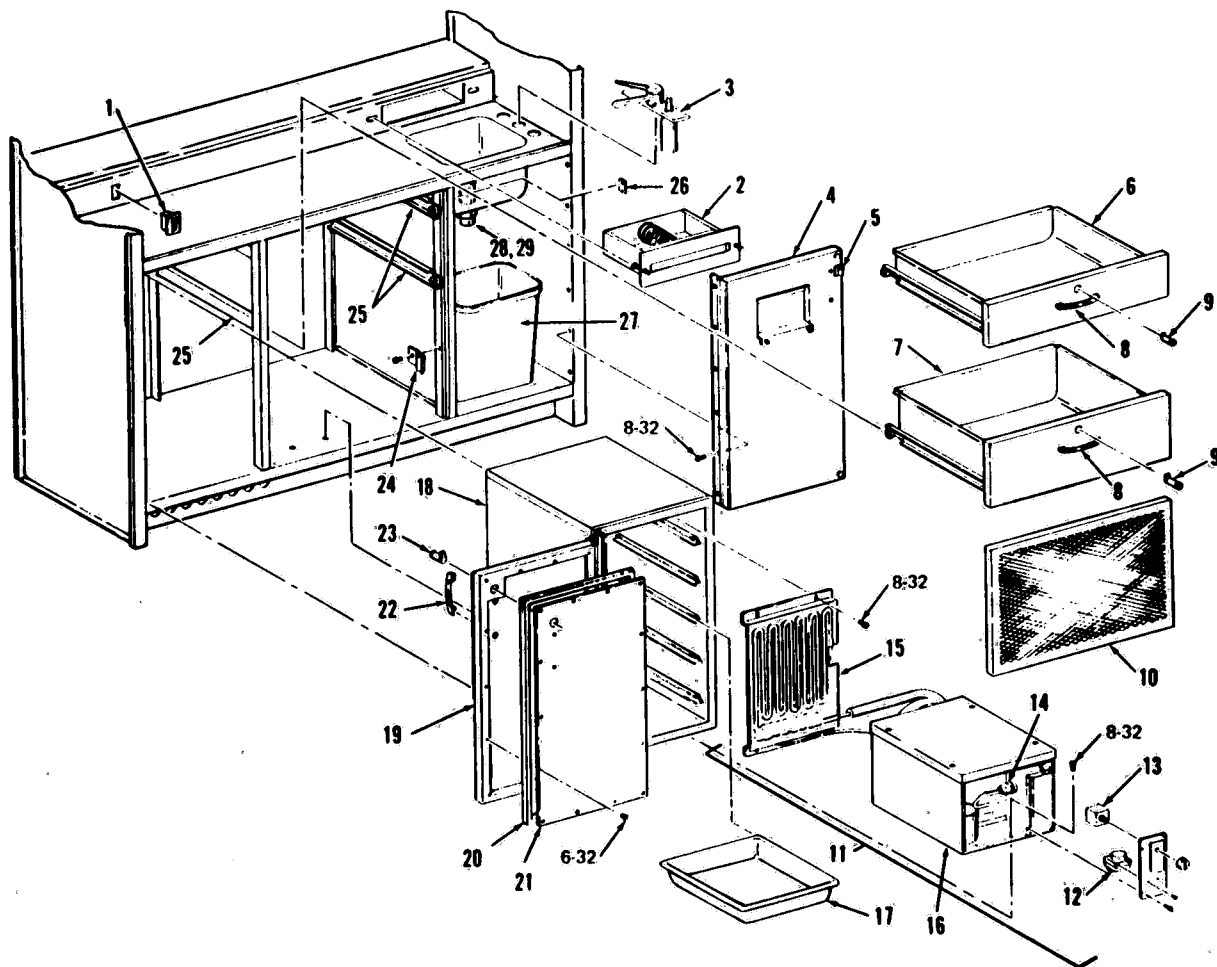

Figure 5-2. LOWER SECTION COMPONENTS.

THIS PAGE
INTENTIONALLY LEFT
BLANK

FIG. & INDEX NO.	PART NUMBER	DESCRIPTION	UNITS PER ASSEMBLY		
5-2-		LOWER SECTION COMPONENTS, 48" Medicine Station	.	.	.
		LOWER SECTION COMPONENTS, 60" Medicine Station			
		LOWER SECTION COMPONENTS, 72" Medicine Station			
1	431120-091	SWITCH, Fluorescent light	1	1	1
2	465482-091	DISPENSER, Towel	1	1	1
	452062-091	• PAWL FASTENER	2	2	2
3	430067-051	FAUCET AND SOAP DISPENSER ASSEMBLY	1	1	1
		See figure 5-3			
4	460327-091	DOOR, Sink module	1	1	1
5	431118-045	CATCH, Roller	1	1	1
6	460317-091	DRAWER, Upper	1		
	460396-091	DRAWER, Upper		1	
	460398-091	DRAWER, Upper			2
7	461025-003	DRAWER, Lower	1		
	461025-002	DRAWER, Lower		1	
	461025-001	DRAWER, Center			2
	461025-004	DRAWER, Lower			1
8	430061-056	• PULL, Drawer	2	2	4
9	431116-056*	LOCK with keys, Storage drawer	2	2	4
10	460929-003	PANEL, Compressor access	1		
	460929-001	PANEL, Compressor access		1	
	460929-002	PANEL, Compressor access			1
11	467802-091	COMPRESSOR ASSEMBLY
12	452229-091	• TIMER, Defrost (Bristol Model 31378)	1	1	1
13	430332-091	• THERMOSTAT, Temperature control	1	1	1
14	452266-091	• RECEPTACLE, Electrical	1	1	1
15	467746-031	• EVAPORATOR ASSEMBLY	1	1	1
16	430130-091	• COMPRESSOR (Tecumseh, AE 1336AA)	1	1	1
	764322-699	• • FILTER DRYER	1	1	1
	764319-609	• • RELAY, Start	1	1	1
	764321-199	• • OVERLOAD	1	1	1
	759665-001	• • MOTOR, Compressor Fan (Not Shown)	1	1	1
17	465484-091	TRAY, Refrigerator	3	3	3
18	467736-091	REFRIGERATOR ASSEMBLY, Biological
19	465570-091	• DOOR ASSEMBLY, Refrigerator
20	452487-091	• • MAGNETIC GASKET, Door	1	1	1
21	452488-091	• • PLATE, Inside	1	1	1
22	430061-056	• • PULL, Door	1	1	1
23	451276-056*	LOCK with keys, Refrigerator	1	1	1
24	452535-091	CLIP, Panel retaining	2	2	2
25	451263-NLA	SUPPORT, Drawer (left-hand)	2	2	5
	430060-091	• BEARING, Roller	2	2	2
	451264-NLA	SUPPORT, Drawer (right-hand)	2	2	5
	430060-091	• BEARING, Roller	2	2	2
26	431119-045	STRIKE, Catch	1	1	1
27	451277-091	BASKET, Waste	1	1	1
28	413720-045	STRAINER	1	1	1
29	413720-044	TAILPIECE	1	1	1

*To enable the use of existing keys, also specify the key number stamped on the original lock and keys with each replacement order.

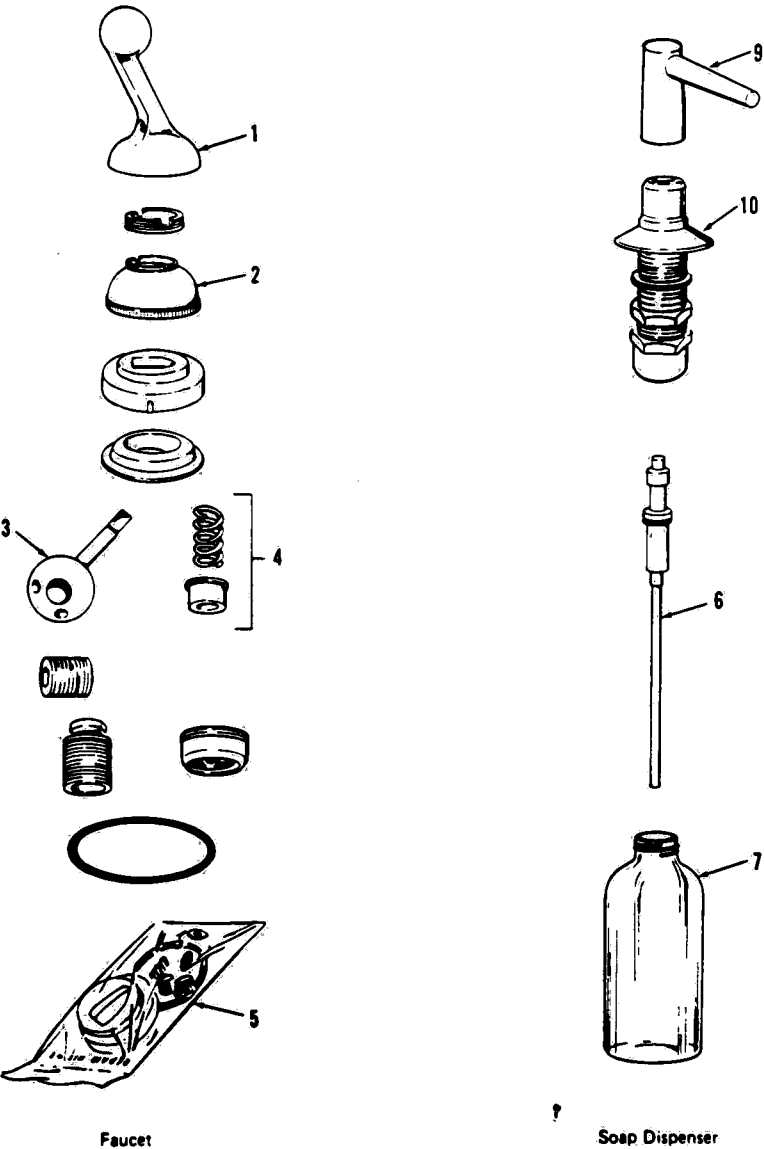

Figure 5-3. FAUCET AND SOAP DISPENSER ASSEMBLY.

FIG. & INDEX NO.	PART NUMBER	DESCRIPTION	UNITS PER ASSEMBLY			
5-3-	430067-051	FAUCET AND SOAP DISPENSER ASSEMBLY	•			
		FAUCET ASSEMBLY	•			
1	754564-091	• HANDLE	1			
2	753169-091	• CAP	1			
3	753168-091	• BALL ASSEMBLY	1			
4	751492-091	• SEAT ASSEMBLY	1			
5	751492-091	• KIT, Repair	1			
	412524-001	SOAP DISPENSER ASSEMBLY	•			
6	412524-004	• PUMP ASSEMBLY	1			
7	412524-005	• BOTTLE, Plastic	1			
8		(NOT USED)				
9	412524-002	• HEAD ASSEMBLY	1			
10	412524-003	• SUPPORT	1			
		• • ADAPTER, Inlet	1			

Service Bulletin Number							
-------------------------	--	--	--	--	--	--	--



**AMSCO
SERVICE**

MEDI-STAT MEDICINE STATIONS 48" 60" 72" P-756518-002 FOURTH GENERATION

2/89

1 of 1

